



Calpe

## Apartament przy plaży

Numer oferty: 4933

**Od 680000 €**

\*Cena nie zawiera podatku VAT



Termin oddania:



### Informacje o nieruchomości

**Typ:** Apartament

**Ilość łazienek:** 2

**Ilość sypialni:** 3

**Powierzchnia:** 73.81 m<sup>2</sup>

**Miasto:** Calpe













### Opis nieruchomości

Ekskluzywna nieruchomość z bezpośrednim dostępem do plaży. Szlachetne materiały i ogromna ilość roślinności zapewniają doskonałą harmonię między domami a środowiskiem naturalnym, w którym się znajdują. Mieszkania i penthousy z dużymi, jasnymi przestrzeniami i spektakularnymi tarasami o powierzchni ponad 20 m<sup>2</sup> w większości nieruchomości, które dzięki przeszklonym balustradom oferują wspaniałe widoki.

Apartamenty, penthouse'y z 1, 2, 3 i 4 sypialniami i wspaniałymi tarasami. Z widokiem na morze na wzgórzu przed „Isla del Fraile” ze spektakularnymi widokami. Apartamenty zostały zaprojektowane tak, aby jak najlepiej wykorzystać naturalne światło i spektakularne widoki na Morze Śródziemne z ich dużych tarasów.



## Atuty

- |   |  |  |
|---|--|--|
|  Pierwsza linia brzegowa |  Klimatyzacja |  Basen ogólnodostępny |
|  Balkon/taras            |  Blisko morza |  Parking              |
|  Winda                   |  Ogród        |  Garaż                |
|  Osiedle zamknięte      |  |  |



## Co otrzymamy w cenie

- |  |  |
|--|--|
|  Umebrowana kuchnia |  Basen ogólnodostępny |
|  Klimatyzacja       |  Łazienka umebrowana  |



## Galeria

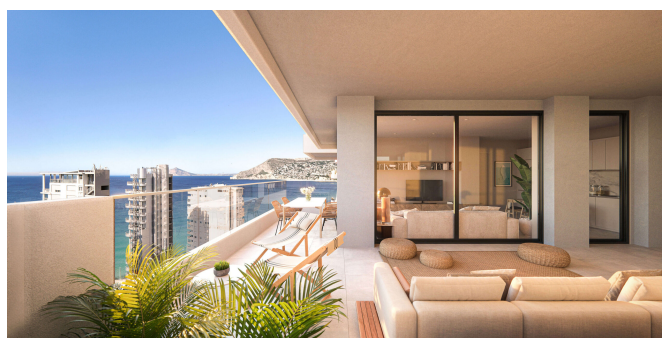



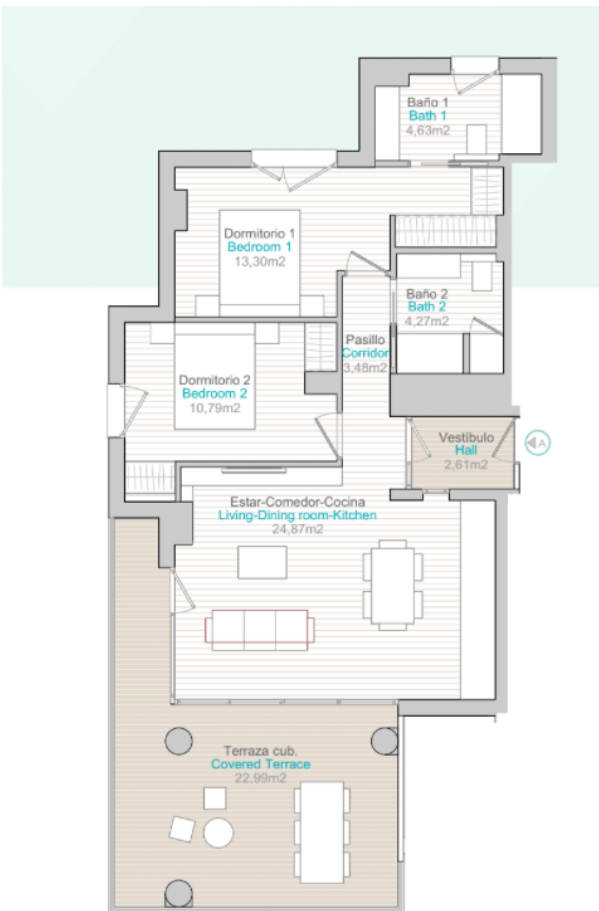
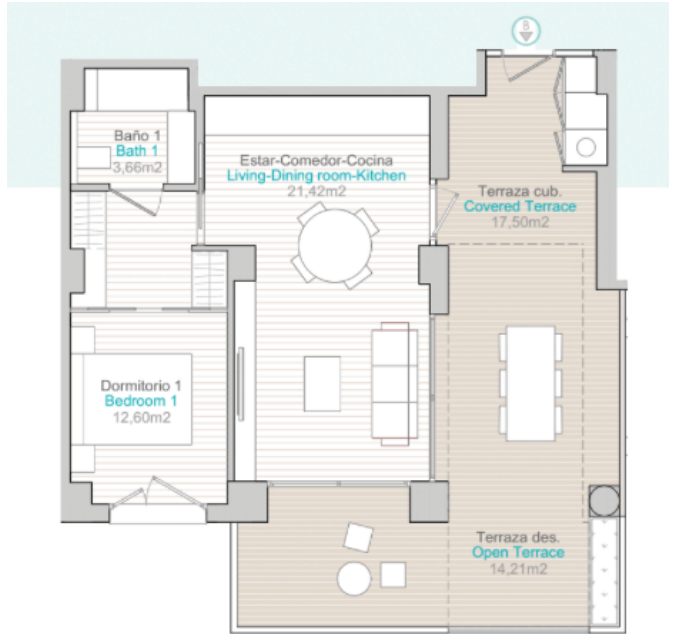
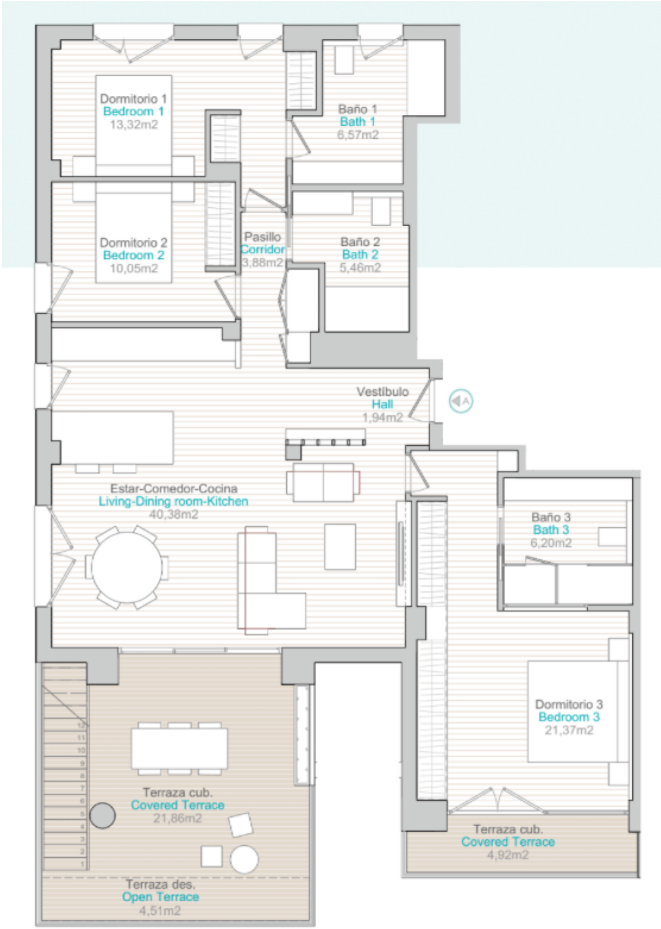

Tower	Floor	Door	Apartment	Bedrooms	Net sq. Apartments	Instr build sqm	Covered terrace	Open terrace	Solarium	Total terrace	Total build sqm	Orientation	TOTAL PRICE [VAT net inc.]	VAT	TOTAL PRICE [VAT inc.]	
7	7	A	1.A	2	62,44	77,07	28,87	6,67	0,00	35,54	132,44	OESTE	RESERVED			
7	7	B	1.B	1	22,66	46,11	16,85	15,20	0,00	32,05	88,28	OESTE	RESERVED			
7	7	C	1.C	2	44,77	61,06	20,94	10,89	0,00	31,83	112,89	ESTE	RESERVED			
7	7	A	2.A	2	43,82	78,50	12,30	17,92	0,00	30,20	110,80	OESTE	RESERVED			
7	7	B	2.B	1	36,83	45,30	14,43	5,79	0,00	20,22	66,52	OESTE	RESERVED			
7	7	C	2.C	2	46,95	61,26	20,03	6,98	0,00	26,01	110,26	ESTE	RESERVED			
7	7	A	3.A	2	41,33	75,37	20,83	6,50	0,00	27,33	102,70	OESTE	RESERVED			
7	7	B	3.B	1	36,83	44,61	16,50	12,57	0,00	29,06	76,36	CENTRAL	RESERVED			
7	7	C	3.C	2	42,2	76,49	20,79	2,53	0,00	23,32	100,21	ESTE	RESERVED			
7	7	A	4.A	2	42,44	77,07	22,19	2,53	0,00	24,72	111,76	OESTE	RESERVED			
7	7	B	4.B	1	36,83	45,32	15,11	6,79	0,00	21,90	68,27	CENTRAL	RESERVED			
7	7	C	4.C	2	42,79	76,49	20,46	6,80	0,00	27,26	112,65	ESTE	RESERVED			
7	7	A	5.A	2	42,44	77,07	24,52	10,23	0,00	34,75	111,84	OESTE	RESERVED			
7	7	B	5.B	1	36,83	44,39	19,99	12,83	0,00	32,82	76,41	CENTRAL	RESERVED			
7	7	C	5.C	2	46,32	61,26	20,80	6,86	0,00	27,66	112,11	ESTE	RESERVED			
7	7	A	6.A	2	42,2	76,49	21,29	10,20	0,00	31,49	113,68	OESTE	RESERVED			
7	7	B	6.B	1	36,83	45,30	16,79	5,79	0,00	22,58	68,48	CENTRAL	RESERVED			
7	7	C	6.C	2	42,83	76,50	16,79	27,67	0,00	44,47	124,17	ESTE	RESERVED			
7	7	A	7.A	2	42,44	77,07	26,84	9,40	0,00	36,24	114,69	OESTE	RESERVED			
7	7	B	7.B	1	36,83	44,39	16,79	12,57	0,00	29,36	76,34	CENTRAL	RESERVED			
7	7	C	7.C	2	42,54	75,37	23,22	0,20	0,00	23,42	102,69	ESTE	RESERVED			
7	7	A	8.A	2	44,44	77,07	26,79	2,03	0,00	28,79	107,80	OESTE	RESERVED			
7	7	B	8.B	1	36,83	45,30	16,26	5,78	0,00	22,04	68,31	CENTRAL	RESERVED			
7	7	C	8.C	2	42,82	76,50	16,26	27,79	0,00	44,05	119,29	OESTE	RESERVED			
7	7	A	9.A	2	42,82	76,50	16,26	27,79	0,00	44,05	119,29	OESTE	RESERVED			
7	7	B	9.B	1	36,83	44,39	16,26	12,57	0,00	28,83	76,34	CENTRAL	RESERVED			
7	7	C	9.C	2	42,82	76,50	16,26	27,79	0,00	44,05	119,29	OESTE	RESERVED			
7	7	A	10.A	2	42,82	76,50	16,26	27,79	0,00	44,05	119,29	OESTE	RESERVED			
7	7	B	10.B	1	36,83	44,39	16,26	12,57	0,00	28,83	76,34	CENTRAL	RESERVED			
7	7	C	10.C	2	42,82	76,50	16,26	27,79	0,00	44,05	119,29	OESTE	RESERVED			
7	7	A	11.A	2	42,22	76,49	20,46	4,47	0,00	24,93	111,42	OESTE	RESERVED			
7	7	B	11.B	1	36,83	44,39	16,79	12,83	0,00	29,62	76,41	CENTRAL	RESERVED			
7	7	C	11.C	2	42,22	76,49	20,46	4,47	0,00	24,93	111,42	OESTE	RESERVED			
7	7	A	12.A	2	42,22	76,49	20,46	4,47	0,00	24,93	111,42	OESTE	RESERVED			
7	7	B	12.B	1	36,83	44,39	16,79	12,83	0,00	29,62	76,41	CENTRAL	RESERVED			
7	7	C	12.C	2	42,22	76,49	20,46	4,47	0,00	24,93	111,42	OESTE	RESERVED			
7	7	A	13.A	2	42,44	77,07	26,84	12,62	0,00	39,46	119,44	OESTE	RESERVED			
7	7	B	13.B	1	36,83	45,30	14,43	5,79	0,00	20,22	66,52	OESTE	RESERVED			
7	7	C	13.C	2	42,44	77,07	26,84	12,62	0,00	39,46	119,44	OESTE	RESERVED			
7	7	A	14.A	2	42,82	76,50	16,26	27,79	0,00	44,05	119,29	OESTE	RESERVED			
7	7	B	14.B	1	36,83	44,39	16,26	12,57	0,00	28,83	76,34	CENTRAL	RESERVED			
7	7	C	14.C	2	42,82	76,50	16,26	27,79	0,00	44,05	119,29	OESTE	RESERVED			
7	7	A	15.A	2	42,82	76,50	16,26	27,79	0,00	44,05	119,29	OESTE	RESERVED			
7	7	B	15.B	1	36,83	44,39	16,26	12,57	0,00	28,83	76,34	CENTRAL	RESERVED			
7	7	C	15.C	2	42,82	76,50	16,26	27,79	0,00	44,05	119,29	OESTE	RESERVED			
7	7	A	16.A	2	42,82	76,50	16,26	27,79	0,00	44,05	119,29	OESTE	RESERVED			
7	7	B	16.B	1	36,83	44,39	16,26	12,57	0,00	28,83	76,34	CENTRAL	RESERVED			
7	7	C	16.C	2	42,82	76,50	16,26	27,79	0,00	44,05	119,29	OESTE	RESERVED			
7	7	A	17.A	3	76,91	111,35	34,26	8,19	0,00	42,45	118,60	OESTE	RESERVED	800.000	85.000	985.000
7	7	C	17.C	2	72,65	90,20	24,60	0,20	0,00	24,80	117,20	OESTE	RESERVED			
7	7	A	18.A	1	36,83	44,67	14,62	5,79	0,00	20,41	65,69	OESTE	RESERVED			
7	7	B	18.B	2	42,44	77,07	26,84	12,62	0,00	39,46	119,44	OESTE	RESERVED			
7	7	C	18.C	2	42,44	77,07	26,84	12,62	0,00	39,46	119,44	OESTE	RESERVED			
7	7	A	19.A	1	36,83	44,62	14,39	2,40	0,00	16,79	56,41	CENTRAL	RESERVED			
7	7	B	19.B	2	42,44	77,07	26,84	12,62	0,00	39,46	119,44	OESTE	RESERVED			
7	7	C	19.C	2	42,44	77,07	26,84	12,62	0,00	39,46	119,44	OESTE	RESERVED			
7	17	A	17.A	3	76,91	111,35	34,26	8,19	0,00	42,45	118,60	OESTE	RESERVED	800.000	85.000	985.000
7	17	C	17.C	2	72,65	90,20	24,60	0,20	0,00	24,80	117,20	OESTE	RESERVED			

1	1	A	1.8	2	62.64	72.07	26.87	4.87	188.38	191.45	228.89	CEST	RESERVED			
2	1	B	1.8	1	27.68	46.71	18.85	0.30	0.00	34.15	80.28	CENTRAL	RESERVED			
3	1	C	1.2	2	66.7	81.28	26.94	18.89	0.00	21.83	121.81	EST	RESERVED			
4	2	A	2.4	2	43.82	29.50	12.38	0.79	0.00	41.16	124.46	CEST	RESERVED			
5	2	B	1.8	1	70.81	45.25	14.63	5.78	0.00	20.42	61.71	CENTRAL	RESERVED			
6	2	C	2.2	2	44.19	81.25	25.02	4.88	0.00	29.89	171.74	EST	RESERVED			
7	3	A	3.6	2	81.34	75.31	24.81	6.80	0.00	21.31	102.10	CEST	RESERVED			
8	3	B	2.8	1	36.83	44.41	16.38	12.57	0.00	31.95	76.36	CENTRAL	RESERVED			
9	3	C	2.2	2	62.2	76.49	23.99	2.71	0.00	37.40	171.89	EST	RESERVED			
10	4	A	4.8	2	42.44	72.07	22.16	1.73	0.00	37.37	114.38	CEST	RESERVED			
11	4	B	4.8	1	36.81	45.25	15.11	9.79	0.00	26.40	76.20	CENTRAL	RESERVED			
12	4	C	2.2	2	42.19	76.49	29.66	4.00	0.00	36.16	112.64	EST	RESERVED			
13	5	A	5.8	2	62.44	72.07	24.12	10.11	0.00	32.27	171.84	CEST	RESERVED			
14	5	B	5.8	1	36.81	44.28	19.99	12.02	0.00	22.43	76.41	CENTRAL	RESERVED			
15	5	C	2.2	2	46.12	81.05	22.89	8.86	0.00	31.38	152.47	EST	RESERVED			
16	6	A	6.8	2	62.2	76.49	27.39	5.52	0.00	22.72	109.27	CEST	RESERVED			
17	6	B	6.8	1	36.83	45.30	15.79	9.79	0.00	21.08	46.38	CENTRAL	RESERVED			
18	6	C	2.2	2	43.81	79.50	16.79	12.62	0.00	44.41	151.71	EST	RESERVED			
19	7	A	7.8	2	62.44	72.07	26.44	12.77	0.00	46.15	122.22	CEST	RESERVED			
20	7	B	7.8	1	36.83	44.28	16.38	12.62	0.00	21.34	76.34	CENTRAL	RESERVED			
21	7	C	2.2	2	41.34	75.37	27.32	0.00	0.00	27.32	102.49	EST	RESERVED			
22	8	A	8.8	2	62.44	72.07	26.75	6.00	0.00	26.75	105.47	CEST	RESERVED			
23	8	B	8.8	1	36.83	45.30	15.26	9.19	0.00	20.41	45.71	CENTRAL	RESERVED			
24	8	C	2.2	2	72.64	89.48	24.47	6.28	0.00	15.82	122.40	EST	RESERVED			
25	9	A	9.8	2	61.82	76.50	12.38	10.72	0.00	41.10	122.40	CEST	RESERVED			
26	9	B	9.8	1	37.58	46.21	21.91	2.77	0.00	21.90	60.07	CENTRAL	RESERVED			
27	9	C	2.2	2	72.84	80.25	22.77	4.44	0.00	31.41	121.43	EST	RESERVED			
28	10	A	10.8	2	61.82	76.50	12.38	10.72	0.00	41.10	122.40	CEST	RESERVED			
29	10	B	10.8	1	36.82	44.29	16.79	12.58	0.00	21.95	76.54	CENTRAL	RESERVED			
30	10	C	2.2	2	82.41	77.07	29.06	16.48	0.00	48.52	126.99	EST	RESERVED			
31	11	A	11.8	2	72.83	89.48	26.12	10.01	0.00	36.54	126.22	CEST	RESERVED			
32	11	B	11.8	1	36.83	45.31	14.63	9.79	0.00	20.42	45.72	CENTRAL	RESERVED			
33	11	C	2.2	2	62.44	72.07	22.02	5.72	0.00	26.76	105.42	EST	RESERVED			
34	12	A	12.8	2	62.22	76.49	30.46	4.47	0.00	34.99	111.42	CEST	RESERVED			
35	12	B	12.8	1	36.81	44.29	15.79	12.02	0.00	21.82	76.41	CENTRAL	RESERVED			
36	12	C	2.2	2	72.81	80.25	21.89	12.74	0.00	33.94	124.74	EST	RESERVED			
37	13	A	13.8	2	62.44	72.07	26.40	12.62	0.00	42.37	118.44	CEST	RESERVED			
38	13	B	13.8	1	36.81	45.30	14.63	9.79	0.00	20.40	45.71	CENTRAL	RESERVED			
39	13	C	2.2	2	72.81	89.48	21.41	1.01	0.00	22.42	121.11	EST	RESERVED	600.000	60.000	748.000
40	14	A	14.8	2	72.83	80.25	21.89	9.47	0.00	31.47	121.44	CEST	RESERVED			
41	14	B	14.8	1	36.81	44.29	16.26	12.02	0.00	21.83	76.41	CENTRAL	RESERVED			
42	14	C	2.2	2	43.81	79.50	15.89	27.42	0.00	43.81	123.27	EST	RESERVED			
43	15	A	15.8	2	72.83	89.48	24.68	10.06	0.00	35.54	126.20	CEST	RESERVED			
44	15	B	15.8	1	36.89	44.47	14.63	9.79	0.00	20.42	46.09	CENTRAL	RESERVED			
45	15	C	2.2	2	86.56	77.26	18.06	6.00	0.00	26.90	101.27	EST	RESERVED			
46	16	A	16.8	2	72.83	80.21	22.06	9.38	0.00	31.40	121.43	CEST	RESERVED	725.000	75.500	874.500
47	16	B	16.8	1	36.82	44.28	20.99	2.48	0.00	20.97	76.30	CENTRAL	RESERVED			
48	16	C	2.2	2	42.44	72.07	26.99	6.89	0.00	36.79	118.88	EST	RESERVED			
49	17	A	17.8	2	76.11	81.26	19.06	6.17	0.00	21.21	118.28	CEST	RESERVED	810.000	81.000	931.000
50	17	B	17.8	1	37.66	45.30	17.16	4.60	0.00	33.06	70.36	CENTRAL	RESERVED	410.000	41.000	511.000
51	17	C	2.2	2	17.81	40.22	11.40	4.12	18.20	38.32	120.74	EST	RESERVED	810.000	81.000	931.000
52	18	A	18.8	2	120.11	120.11	120.11	0.00	188.28	191.45	120.11	CEST	RESERVED	1.810.000	181.000	2.151.000
53	18	B	18.8	1	36.8	45.30	16.30	4.87	188.38	191.45	120.89	EST	RESERVED			

**Kasia Wabia**

**Aria Home Invest S.L.U**

+48 601 56 88 44

+34 674 427 308

hello@ariarealestate.eu

www.ariarealestate.eu

